

# Product Disposal Guide

Applicable to: **BRIGHT Sunbell 2.0 Y & 80**

This page contains basic information that should help recycling facilities, as well as users to dispose of the product at its end of life. Local legislations must be always taken into consideration.

But before taking materials to their next life, have you considered and tried extending the lamp's life by repairing it? You can check our repair guides at [www.bright-products.com/repair](http://www.bright-products.com/repair) or by scanning the QR code:



BRIGHT products are made of several materials, that may and should be dismantled for recycling or disposal. Use the image below as a breakdown of the main components:

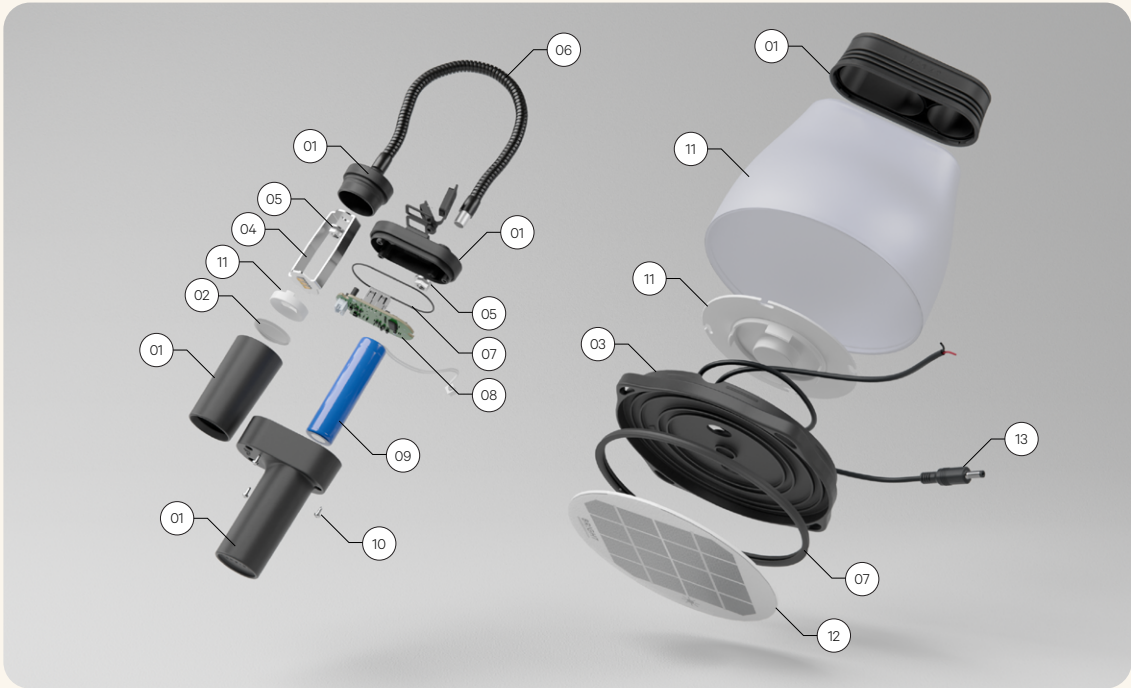

**BRIGHT Sunbell** was developed with ease of disassembly in mind. Using standard tools and following simple steps facilitates repair or the segregation of materials for recycling.

Item	Material	Weight	Disposal as
01	Polypropylene components	51.0 grs.	Plastic
02	Polymethyl methacrylate	1.6 grs.	Plastic
03	Acrylonitrile Butadiene Styrene	58.0 grs.	Plastic
04	Printed circuit board aluminum frame	6.5 grs.	eWaste
05	Steel alloy	3.0 grs.	Metal
06	Powder coated Steel	46 grs.	Metal
07	Thermopolyurethane	8.0 grs.	Plastic
08	Composite Printed Circuit Board	9.0 grs.	eWaste
09	Lithium Ion Battery	39.0 grs.	eWaste
10	Steel alloy	0.5 grs.	Metal
11	Polypropylene, White/Unpigmented	98.5 grs.	Plastic
12	Glass layered photovoltaic cell	68.5 grs.	eWaste
13	Copper-core cable / Steel terminals	42.5 grs.	eWaste